

Map

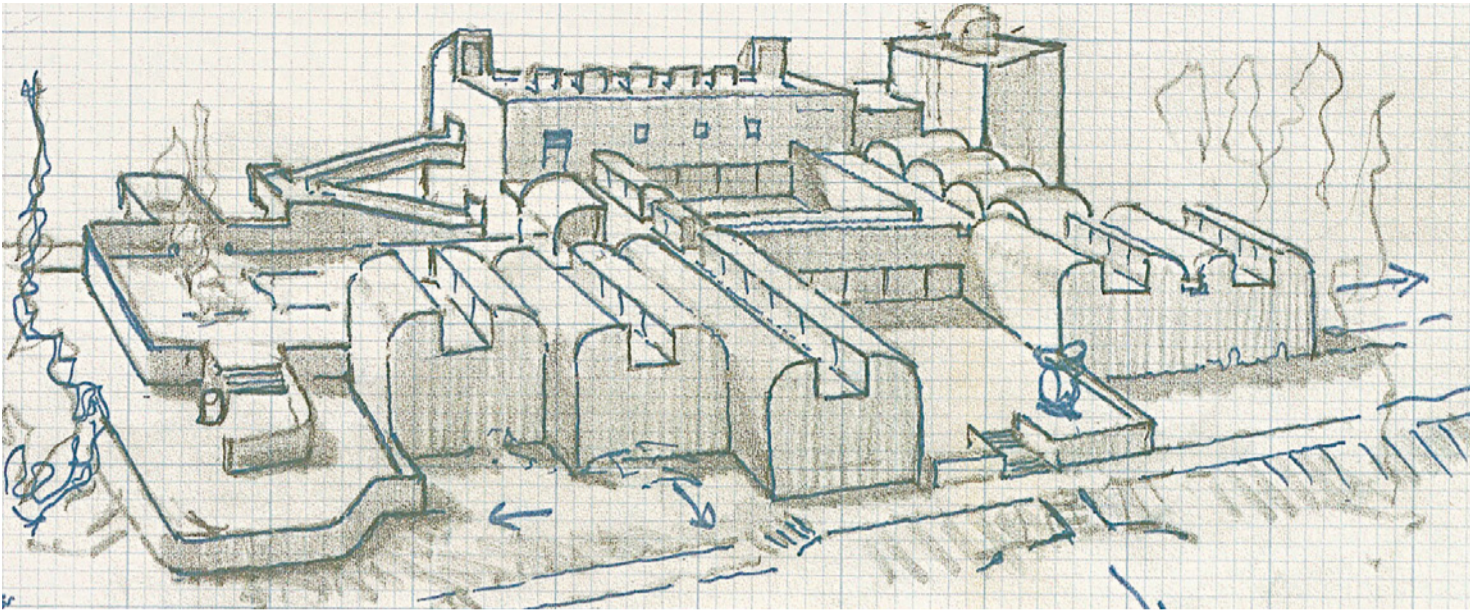

How to get here

The Foundation exhibits the most important public collection of the work of Joan Miró, in a building specifically designed by Josep Lluís Sert to host the artist's production.

The building was created in a rationalist style with Mediterranean traits, harmoniously integrated into the Montjuïc park. The silhouette of the structure in the Barcelona landscape reflects Joan Miró's expressed desire to create a bond between architecture, art and nature.



Headboard image: Josep Lluís Sert. Sketches for the Fundació Joan Miró, n.d. Courtesy of the Frances Loeb Library, Harvard University Graduate School of Design

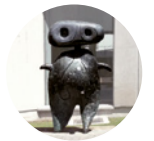

Entrance (A)
Personage, 1970



Gallery 2
Painting (The White Glove), 1925



Gallery 3
Figure in front of the sun, 1968



Gallery 3
The Hope of a Condemned Man, 1974



Gallery 4
Morning Star, 1940



Gallery 4
Man and Woman in Front of a Pile of Excrement, 1935



Gallery 11
Tapestry of the Fundació, 1979



Gallery 11-12 (B)
Mercury Fountain, Alexander Calder, 1937



Gallery 12
Pair of Lovers Playing with Almond Blossoms, Model, 1975



Terrace
Young Girl Escaping, 1967

2

1

0

Joan Miró Collection
Galleries 1-16

Exhibitions
Galleries 17-20

Participatory Space
Galleries 21-22

-1

